



THE ART OF ILLUMINATION

MERIDIAN SERIES INSTALLATION INSTRUCTIONS

Please read all instructions prior to installation & keep for future reference.

1. Omnilight products should be installed by a qualified electrician.
2. Check to ensure power is off at fuse box to prevent electrical shock.
3. Make sure the wattage of the power supply and the product are compatible.
4. Omnilight products can be mounted on most surfaces.
5. Make sure the surface is clean and dry before mounting.



All Omnilight products are cUL and/or cETL listed

Make all connections and test system before installing to surface Installing fixture

1. Connect MPS-24 to lead coming from Omnilight power supply

Wire with writing is Positive (+), wire with black lines (— — —) is negative (-)

2. Plug MPS-24 into lead from Meridian fixture to test
3. Remove white grommets and position fixture under cabinet
4. Install with screws (provided) and/or double stick tape

Do not over tighten screws

5. Replace white grommets.

Meridian series fixtures can be directly connected together using leads from fixture. For longer spaces between fixtures MTM connectors are available in 3", 12", 36" and 72" lengths

1.

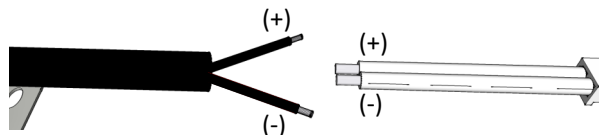

2.

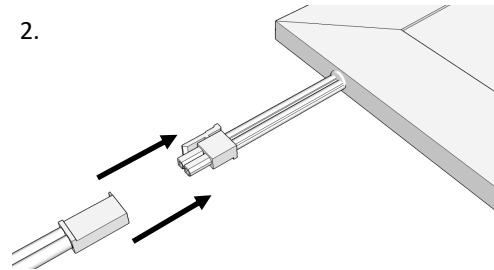

3.

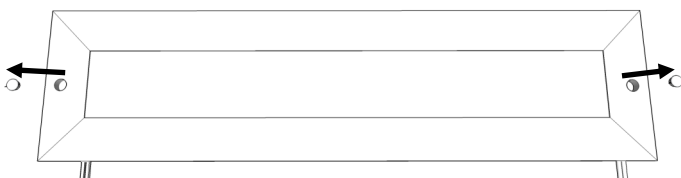

4.

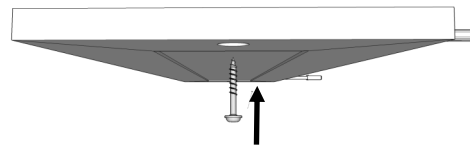

5.

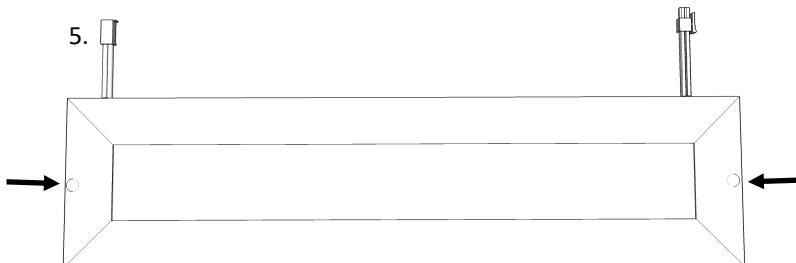

All Omnilight products are tested and warranted for use exclusively with Omnilight power supplies