



THE ART OF ILLUMINATION

ORBIT SERIES INSTALLATION INSTRUCTIONS

Please read all instructions prior to installation & keep for future reference.

1. Omnilight products should be installed by a qualified electrician.
2. Check to ensure power is off at fuse box to prevent electrical shock.
3. Make sure the wattage of the power supply and the product are compatible.
4. Omnilight products can be mounted on most surfaces.
5. Make sure the surface is clean and dry before mounting.



All Omnilight products are cUL and/or cETL listed

Make all connections and test system before installing to surface

- Orbit Pucks are 4 watts each. Do not exceed wattage on power supply!
- Can be recessed mounted or surface mounted (surface mount ring sold separately)
- Pucks need to be wired in parallel and are Constant Voltage

Installing fixture

Recess Mounting of Orbit Puck

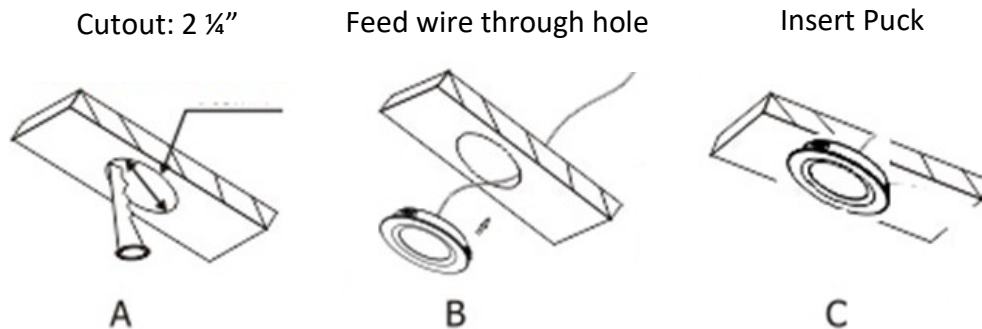

DO NOT PRESS ON LENS TO INSERT PUCK – IT CAN DAMAGE PUCK

Connect wire with RED STRIPE to positive (+) and BLACK wire to negative (-)

Surface Mounting of Orbit Puck

- To surface mount puck use ORB-RING (sold separately)
- Mount ORB-RING in desired location making sure the wire slot is positioned correctly
- Insert puck using the metal housing to apply pressure
(pushing on the lens can damage puck)

All Omnilight products are tested and warranted for use exclusively with Omnilight power supplies